

AZURE – MODERN AUTHENTICATION

1. Follow link:

<https://azure.microsoft.com/en-us/features/azure-portal/>

Log on to Azure portal using the account for Syncmaster.

2. Go to Azure Portal.

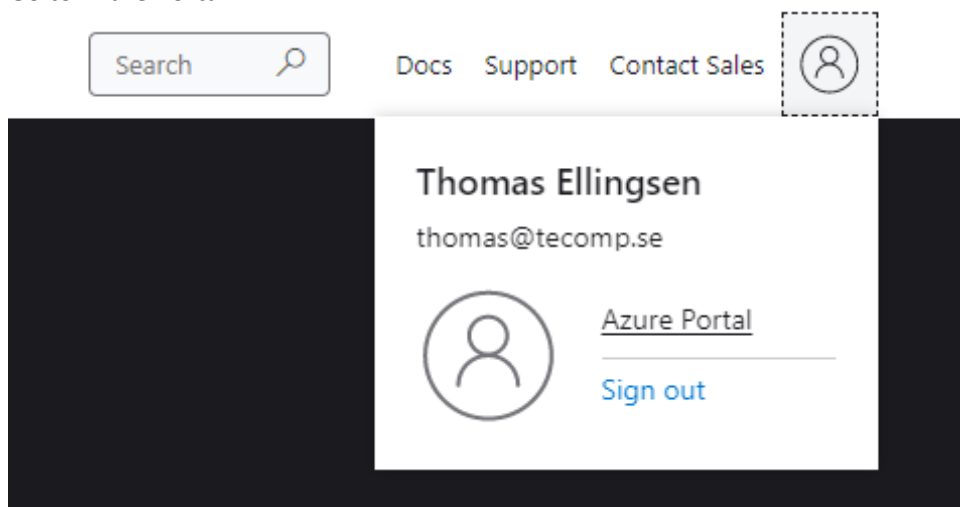

3. Click Azure Active Directory.

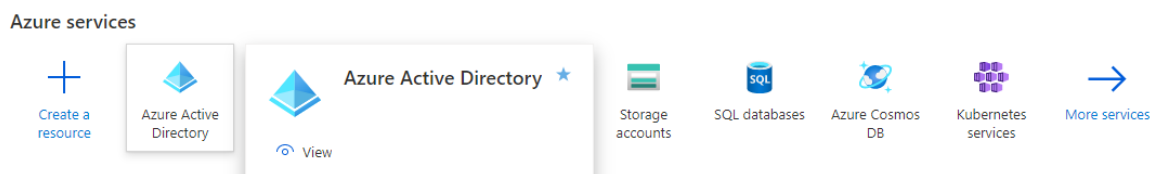

4. Select "APP registrations" and "New registration".

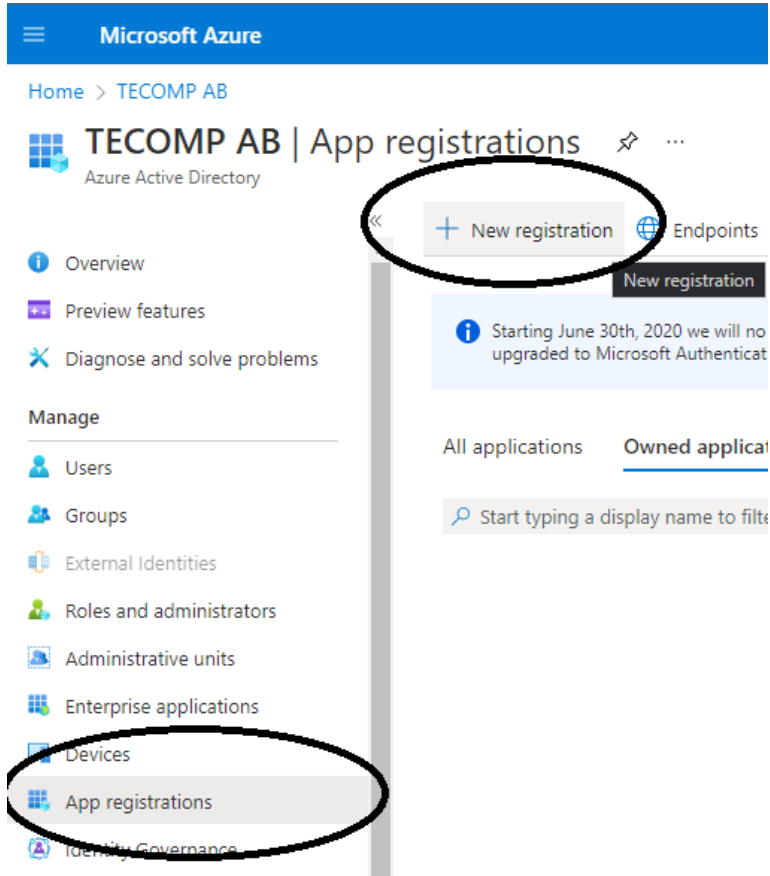

5. Name the app "Syncmaster" and select "Accounts in this org..." Then register app.

Home > TECOMP AB >

Register an application

* Name

The user-facing display name for this application (this can be changed later).

Supported account types

Who can use this application or access this API?

Accounts in this organizational directory only (TECOMP AB only - Single tenant)

- Integration assistant. Select "Desktop app" in the drop down menu. Select "YES" for API. Then click "Evaluate my appreg".

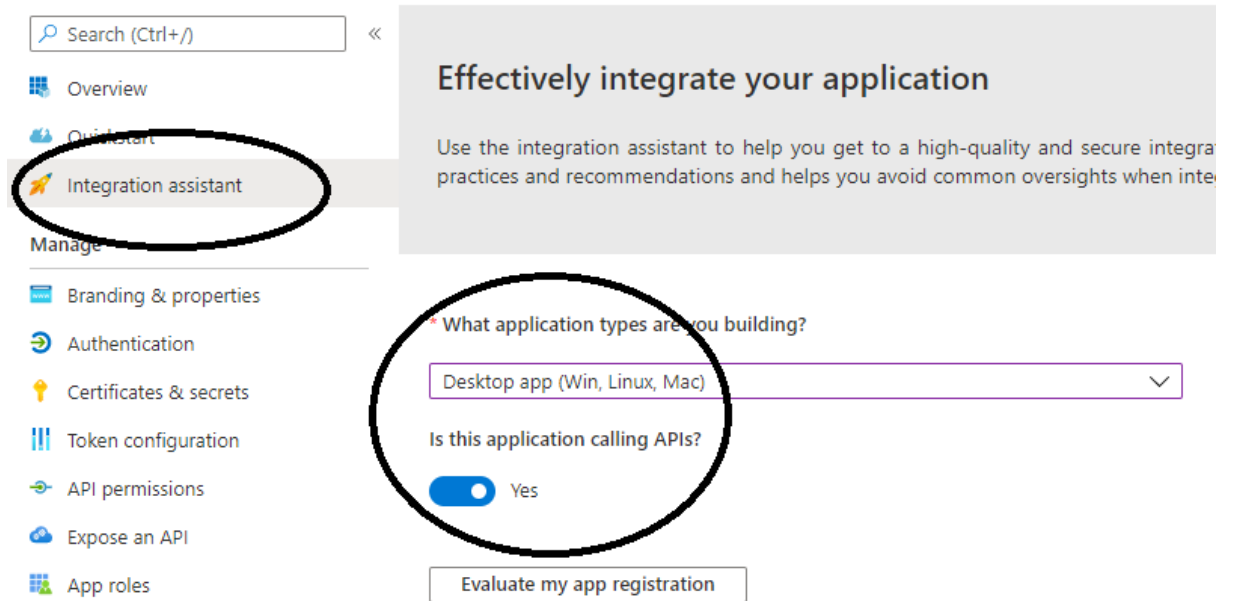

- Two objects require action, Go to context menu "Go to page".

Recommended configurations

Item	Status	
Configure a redirect URI for a desktop app by adding a platform.	Action required	...
Configure API permissions.	Action required	... Context menu
Assign users that should be able to view and edit this application registration as owners.	Complete	...

- Select: Add platform -> Mobile and desktop applications.



9. Enter: `urn:ietf:wg:oauth:2.0:oob` – Then select configure.

Configure Desktop + devices ×

[← All platforms](#) [Quickstart](#) [Docs](#)

Redirect URIs

The URIs we will accept as destinations when returning authentication responses (tokens) after successfully authenticating users. The redirect URI you send in the request to the login server should match one listed here. Also referred to as reply URLs. [Learn more about Redirect URIs and their restrictions](#)

- <https://login.microsoftonline.com/common/oauth2/nativeclient> 
- https://login.live.com/oauth20_desktop.srf (LiveSDK) 
- [msal26befdc8-87fc-4683-94d6-f0656809ade6://auth](#) (MSAL only) 

Custom redirect URIs

`urn:ietf:wg:oauth:2.0:oob` ✓

ConfigureCancel

10. Go back to integration assistant. Action is required for "API – permissions". Select add permission -> "Microsoft Graph" and "Delegated permission". Scroll down to "EWS" and check the box, click "add permission".

11. The registration is completed. Copy Application ID(client) and Directory ID(tenant ID) on the overview menu. Go to Easy Planning and open the maintenance menu, go to Outlook/Syncmaster/Settings - Paste App ID and Directory ID. Don't forget to enter e-mail and password.

Home >

Syncmaster

Search (Ctrl+/) << Delete Endpoints Preview features

Overview

Quickstart

Integration assistant

Manage

Branding & properties

Authentication

Certificates & secrets

Token configuration

API permissions

Expose an API

App roles

Get a second? We would love your feedback on Microsoft identity platform (previously Azure AD for developer).

Essentials

Display name : Syncmaster

Application (client) ID : [REDACTED]

Object ID : dcd904a8-cdf6-46cc-9ba1-ed5bf265f9d6

Directory (tenant) ID : [REDACTED]

Supported account types : [My organization only](#)

Starting June 30th, 2020 we will no longer add any new features to Azure Active Directory Authentication Library. It will be upgraded to Microsoft Authentication Library (MSAL) and Microsoft Graph. [Learn more](#)

[Get Started](#) Documentation

Log on Syncmaster manually the first time. To do this, open Syncmaster, select a user, click "Connect to exchange", enter the password and confirm this by using TAB to highlight "Log in" and then press ENTER by the numpad. Using any other way will not grant permissions.

(ENTER on the right side of the numpad)
